

How to connect TedaIS Wi-Fi networks with Apple Macintosh computer:

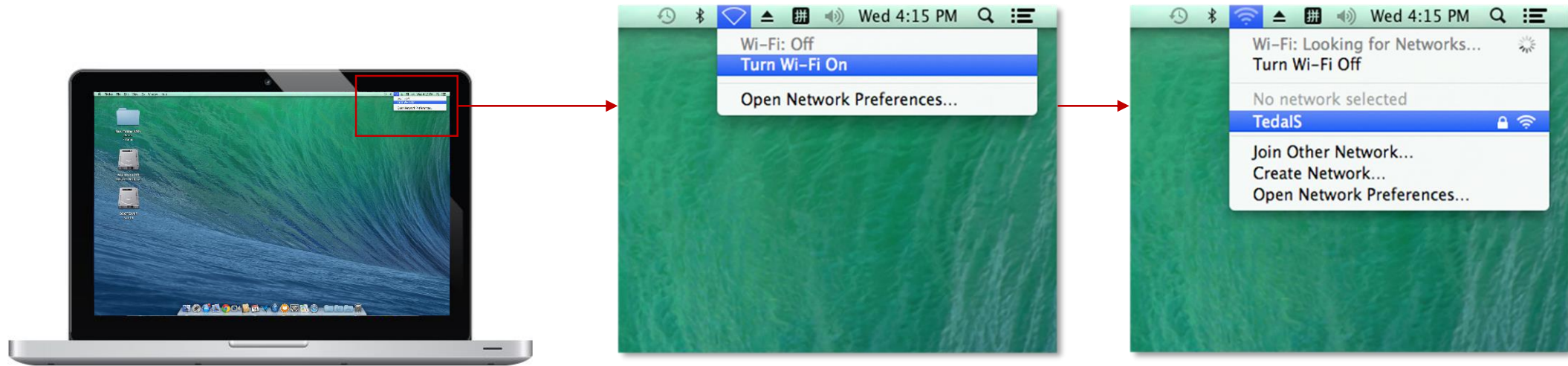

1. Click Wi-Fi icon in top-right of screen, **Turn Wi-Fi On** to search for Wi-Fi networks.
2. While **TedaIS** be found, click it to connect.

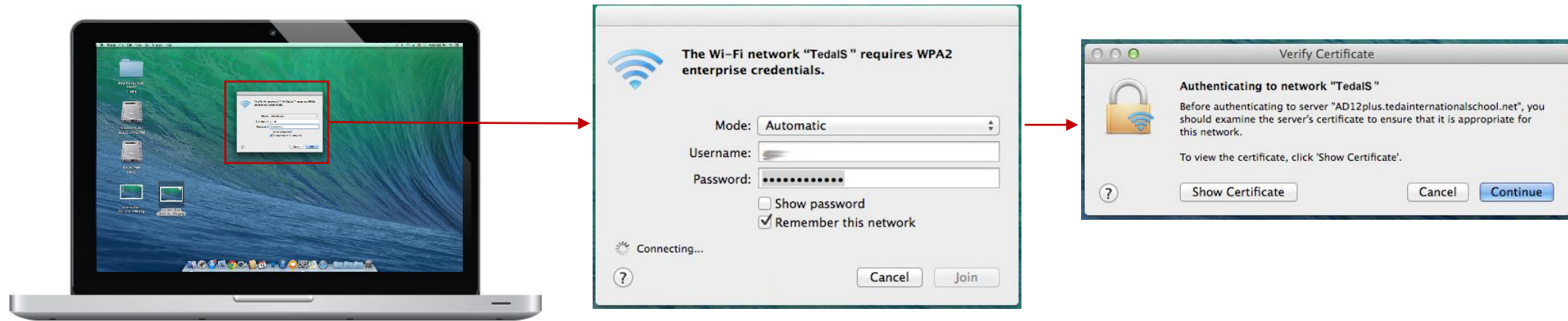

3. You will be prompted to enter the **username** and **password**, it's actually your **Network ID**, same account be used in PC, email, Moodle and copier.



4. Click **Continue** in **Verify Certificate** dialog.

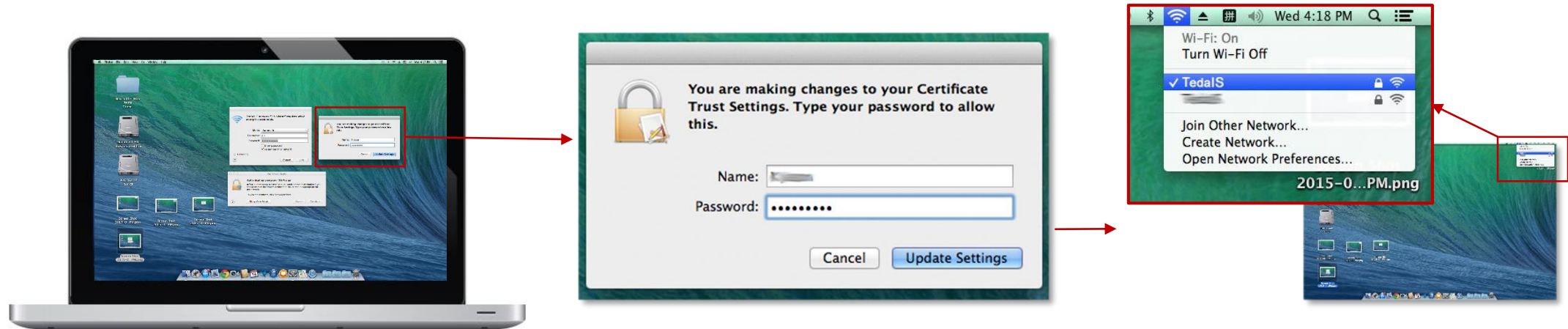

5. You will be prompted to enter the **username** and **password** to update settings, it mean the account of your Mac.
6. When your device is connected to a Wi-Fi network, a checkmark will appear to the left of the network name.